





HOFFMAN

ULTRX®

Screw Insert Kit
Schraubeneinbausatz
Insertion de vis
Juego de insertos de tornillo

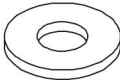
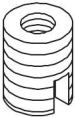

<p>1</p> <p>10-32x.25</p>  <p>(2x)</p>	<p>2</p>  <p>(4x)</p>
<p>3</p>  <p>(4x)</p>	<p>4</p> <p>10-32x.5</p>  <p>(4x)</p>

ENGLISH

* Drive insert into boss until flush with surface.

** Use 10-32 screws to mount components.

20 in-lbs

DEUTSCH

* Einsatz in den Sockel bis zur Oberflächenebene einschlagen.

** 10-32 Schrauben benutzen, um Teile zu montieren.

2.26 Nm

FRANÇAIS

* Visser de Lorce le manchon dans le bossage jusqu'au niveau de la surface.

** Utiliser les vis 10-32 pour monter les éléments.

2.26 Nm

ESPAÑOL

* Hínque el inserto en el saliente hasta que quede raso con la superficie.

** Use tornillos 10-32 para montar los componentes.

2.26 Nm

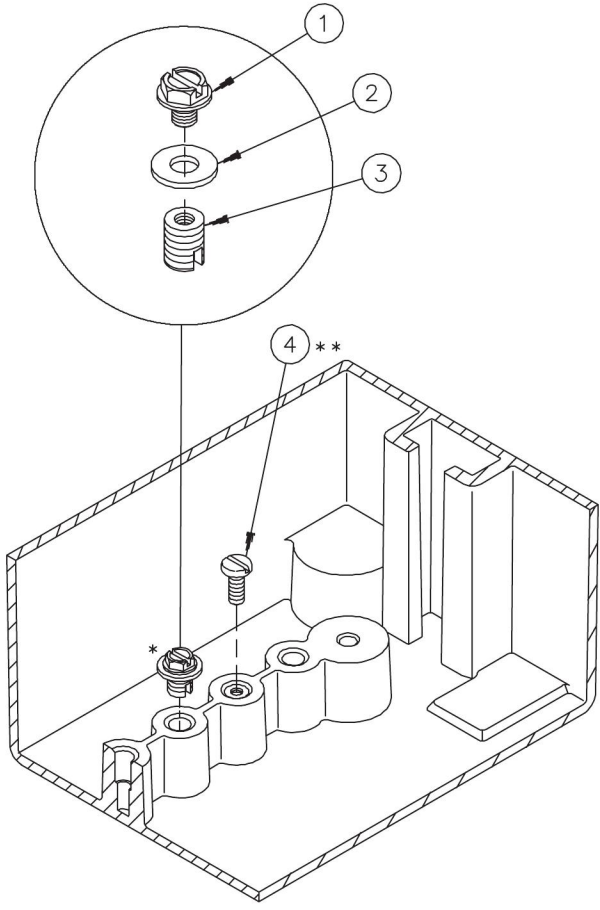



HOFFMAN

